



Dividing is adding.







Separating areas within the same space is easy with panels that also provide acoustic comfort. The learning environment has a deep impact on the educational results of all students. Shall we make the most of every square meter?

Separar zonas en un mismo espacio es fácil con los paneles que además aportan confort acústico. El entorno de aprendizaje tiene un efecto profundo en los resultados educativos de todos los alumnos, ¿le sacamos partido a cada metro cuadrado?



54 m²



30





HEXA

The HEXA table is the paradigm of versatility and storage optimization.

La mesa HEXA es el paradigma de la versatilidad y la optimización en su almacenaje



SAMOS

SAMOS acoustic panels divide spaces and dampen sound, making communication easier.

Los paneles acústicos SAMOS, separan espacios y amortiguan el sonido facilitando la comunicación.



MIA LIFT

Ergonomic MIA chairs favour the natural movement of the body. With padded seat option for extra comfort.

Las sillas ergonómicas MIA facilitan el movimiento natural de cuerpo. Con opción de tapizado para mayor confort.



Learning in motion.



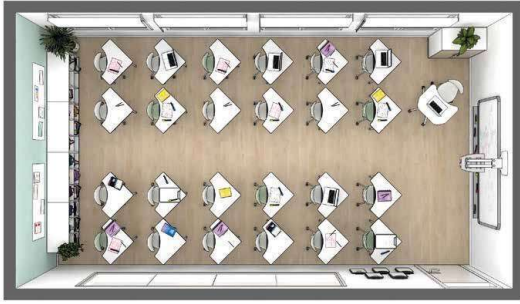

The learning experience needs guidance, but also freedom. Freedom of movement to create and dismantle work groups with versatile tables. Spaces bringing about learning with order and good acoustics to facilitate communication and comfort.

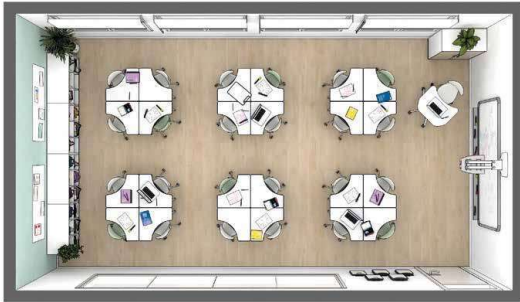

La experiencia del aprendizaje necesita guía, pero también libertad. Libertad de movimiento para agruparse y desagruparse por equipos de trabajo con mesas versátiles. Espacios que sean catalizadores del conocimiento con orden, buena acústica para facilitar la comunicación, comodidad y confort.



45 m²



24





The MINI LILY individual whiteboard and its storage system promote order and debate in the classroom.

La pizarra individual MINI LILY y su sistema de almacenaje facilitan el debate y el orden en el aula

MINI LILY



The MOON table, adjustable in height, provides teachers with the position within the group that they need at all times.

La mesa MOON, regulable en altura, proporciona al profesorado la posición dentro del grupo que necesita en cada momento.

MOON







*Small changes,
big improvements.*

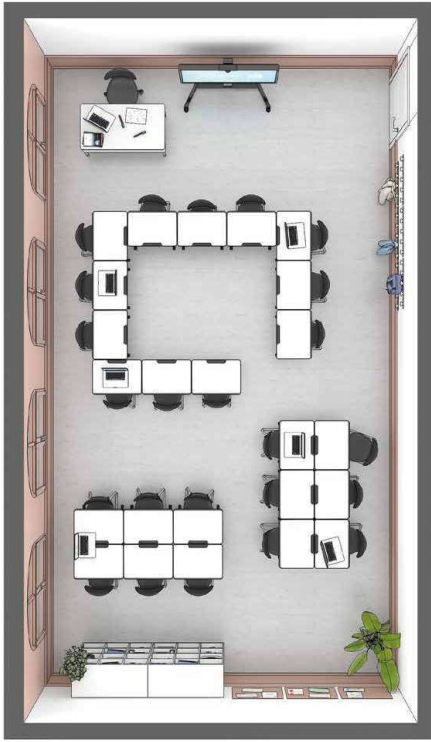

Sometimes, it all comes down to having the ideal chairs and desks to improve concentration, order and comfort, and just letting space and natural light do the rest.

A veces solo es necesario contar con los pupitres y las sillas idóneas para ganar en concentración, orden y confort y dejar que el espacio y la luz natural hagan el resto.



45 m²



24





RECTANGLE TEACHER

The classical teacher's desk with drawer and modesty panel is called RECTANGLE TEACHER.

La clásica mesa para profesorado con cajón y faldón se llama RECTANGLE TEACHER.



MIA CANTILEVER

The MIA CANTILEVER chair helps to optimize cleanliness and order in classrooms.

La silla MIA CANTILEVER ayuda a optimizar la limpieza y el orden en las aulas.

*Welcome to the
superclassroom.*







In multi-purpose spaces with multiple dynamics, the Teaching-how-to-Learn paradigm shift shines. In these areas, the organization of space, time and materials is key to facilitating synergies.

En los espacios polivalentes de múltiples dinámicas es donde brilla el cambio de paradigma de enseñar a aprender. En ellos la organización del espacio, del tiempo y de los materiales es clave para facilitar sinergias.



150 m²



60





MIA TABLE

MIA TABLE chairs with folding table and lower storage tray to easily form and dismantle groups.

Sillas con pala y almacenaje MIA TABLE para agruparse y desagruparse fácilmente.



MIA STORE

Large work tables and MIA STORE chairs with a storage tray so that dynamism in the super classroom does not mean clutter.

Mesas amplias de trabajo y sillas MIA STORE con bandeja para almacenaje para que el dinamismo en la súperaula no altere su orden.



Marga Tubau

Sales Manager

What can make
neurons dance?

A strategically placed sofa.
A panel that turns into a
mobile whiteboard. Let the
desire to learn, share ideas
and contrast them find
their space in any corner.

¿Qué puede hacer que
las neuronas bailen?

Un sofá estratégicamente
ubicado. Un panel que
es una pizarra móvil.
Hagamos que las ganas de
aprender, compartir ideas y
contrastarlas encuentren su
espacio en cualquier rincón.

Tips for corners



A passage area or a corner of 3m² allows a one-on-one meeting.

Una zona de paso o un rincón de 3m² da lugar a una reunión de tú a tú

The combination of grades in different sizes creates a facilitating space for meetings and discussions.

La combinación de gradas de diferentes dimensiones crea el espacio facilitador para el fórum o el debate



Create a discussion area in a classroom: it just takes a sofa, a whiteboard and an acoustic divider.

Crear una zona de debate en un aula: este rincón solo necesita un sofá, una pizarra y divisor acústico



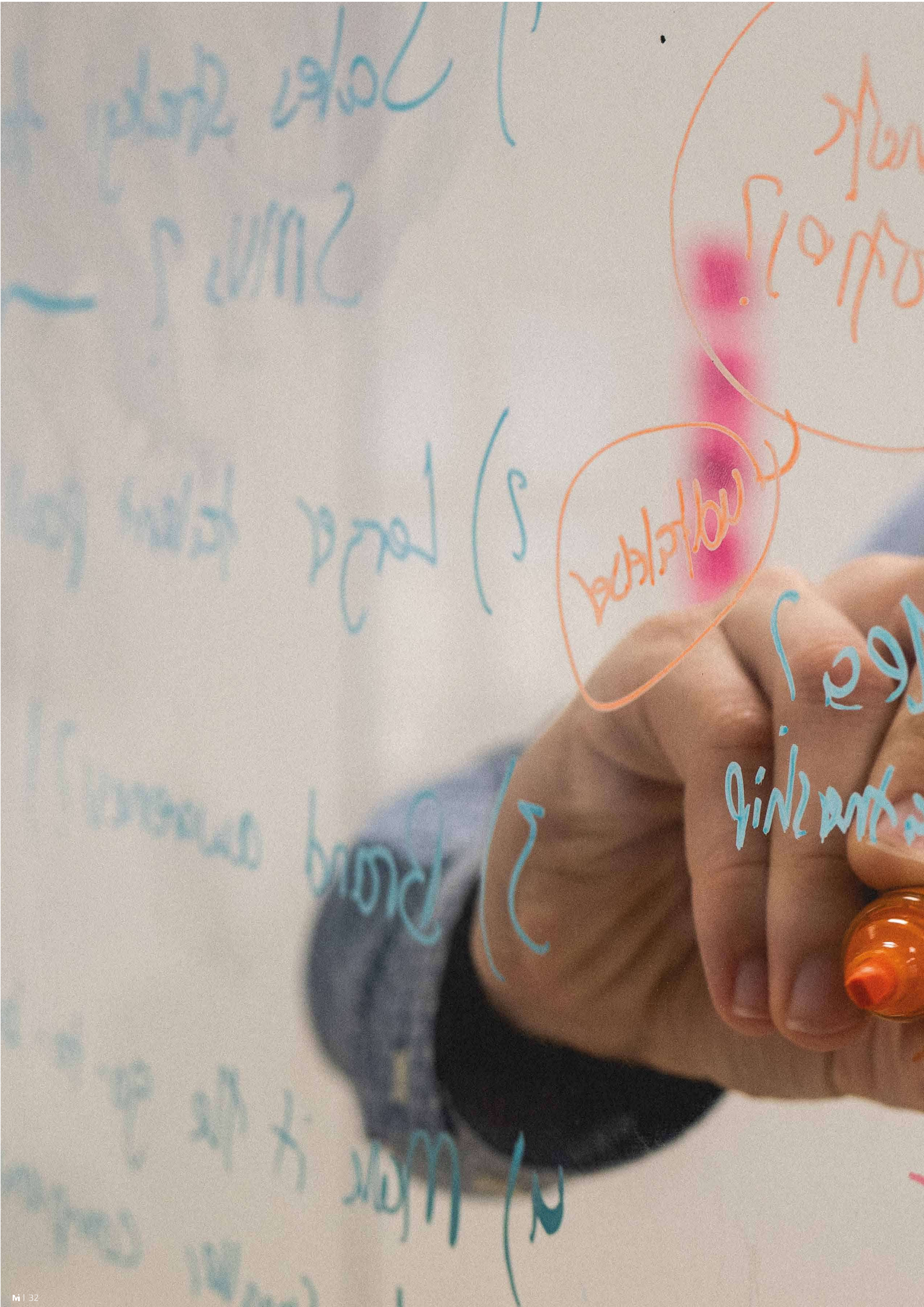

Kultur

Kultur

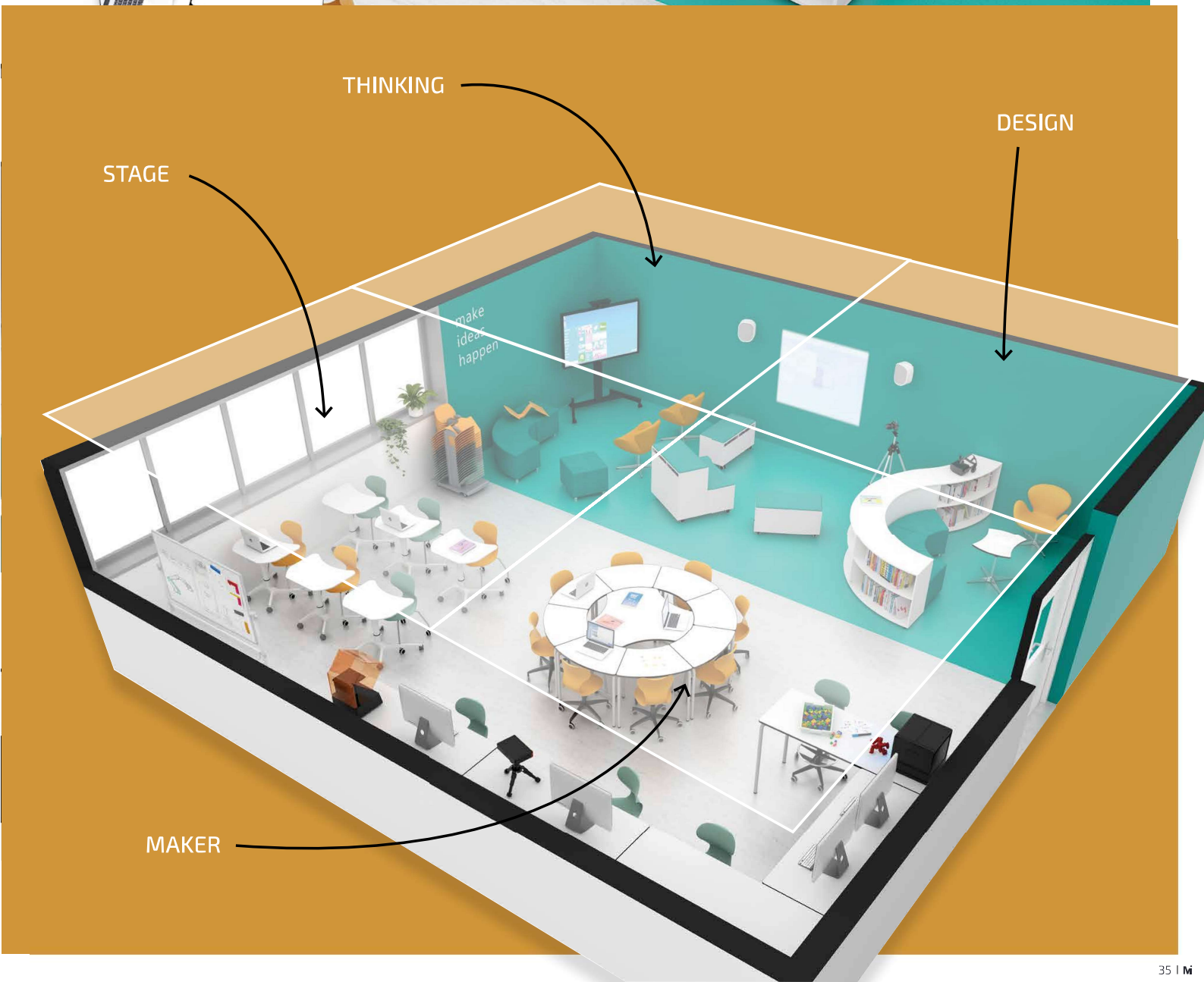

*The same stage
multiple spaces*



make
ideas
happen



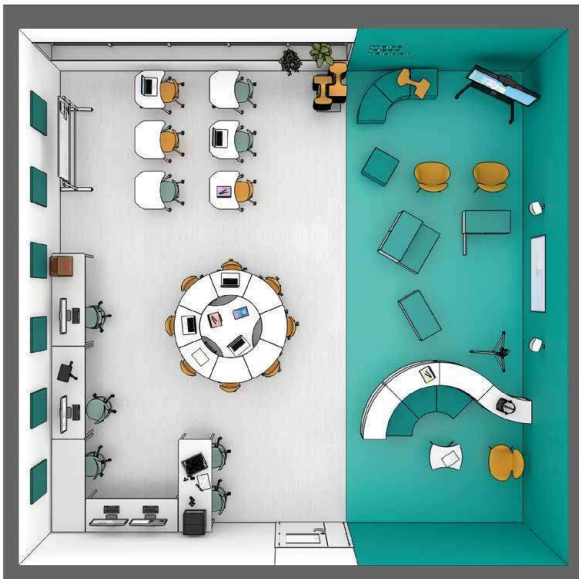

A multidirectional space with zones to carry out different activities related to the same project not only optimizes time and space, but it also fosters concentration and cooperative work.

The goal is to create spaces that are allied with knowledge. Shall we do it?

Un espacio multidireccional con diferentes zonas para diversas actividades relacionadas con la ejecución de un mismo proyecto no solo optimiza tiempo y espacio, también estimula la concentración y el trabajo cooperativo.

El objetivo es crear ambientes que se alíen con el conocimiento. ¿Lo hacemos?



87 m²



40





MOVE

MINI MOVE

MOVE and MINI MOVE grades create a forum area for expositions and debates.

Las gradas MOVE y MINI MOVE crean una zona forum para la exposición y el debate.



OCTA

TRISIX

OCTA and TRISIX tables allow you to quickly create work groups, providing a design zone when needed.

Las mesas OCTA y TRISIX permiten crear ágilmente grupos de trabajo facilitando una zona design cuando se necesita.





Periodic Table of Elements																																	
H	He											Li	Be	B	C	N	O	F	Ne														
Na	Mg	Al	Si	P	S	Cl	Ar	K	Ca	Sc	Ti	V	Cr	Mn	Fe	Co	Ni	Cu	Zn	Ga	Ge	As	Se	Br	Kr								
Rb	Sr	Y	Zr	Nb	Mo	Tc	Ru	Rh	Pd	Ag	Cd	In	Sn	Sb	Te	I	Xe	Cs	Ba	Lanthanides	Hf	Ta	W	Re	Os	Ir	Pt	Au	Hg	Tl	Pb	Bi	Po
Fr	Ra	Actinides	Rf	Db	Sg	Bh	Hl	Hs	Mt	Ds	Rg	Cn	Uu	Uu	Uu	Uu	Uu	Uu	Uu	Uu	Uu	Uu	Uu	Uu	Uu	Uu	Uu	Uu	Uu	Uu	Uu	Uu	
La	Ce	Pr	Nd	Pm	Sm	Eu	Gd	Tb	Dy	Ho	Er	Tm	Yb	Lr																			
Ac	Th	Pa	U	Np	Pu	Am	Cm	Bk	Cf	Es	Fm	Md	No	Lr																			

Ideas lab.





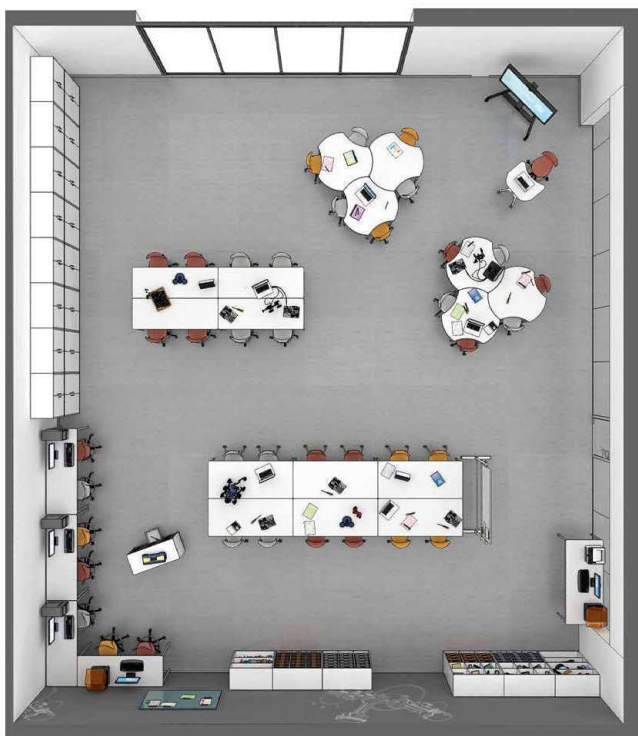

Design contributes to making the educational experience more effective, pleasant and fulfilling in the technology classroom.

Freedom of movement is key here for an agile manipulation of the object of study and the possibility of grouping in small work teams. Whiteboards and mobile auxiliary furniture allow the sharing of ideas and materials

El diseño contribuye a hacer la experiencia educativa más eficaz, placentera y plena en el aula tecnológica.

Aquí la libertad de movimiento para la ágil manipulación del objeto de estudio y la opción de agruparse en equipos de trabajo reducidos es clave. Las pizarras y los muebles auxiliares móviles permiten compartir ideas y materiales.



150 m²



45





MIA STOOL

RECTANGLE PLUS

High and spacious tables, ideal for teamwork and ergonomic stools.
RECTANGLE PLUS table and MIA stools.

Mesas altas y espaciales, idóneas para trabajar en equipo y taburetes ergonómicos.
Mesa RECTANGLE PLUS y taburete MIA STOOL



TRISIX

Versatile and easy to fit tables to form and dismantle work teams.

Mesas versátiles y fácilmente almacenables para agrupar y desagrupar equipos de trabajo.



A small oasis.





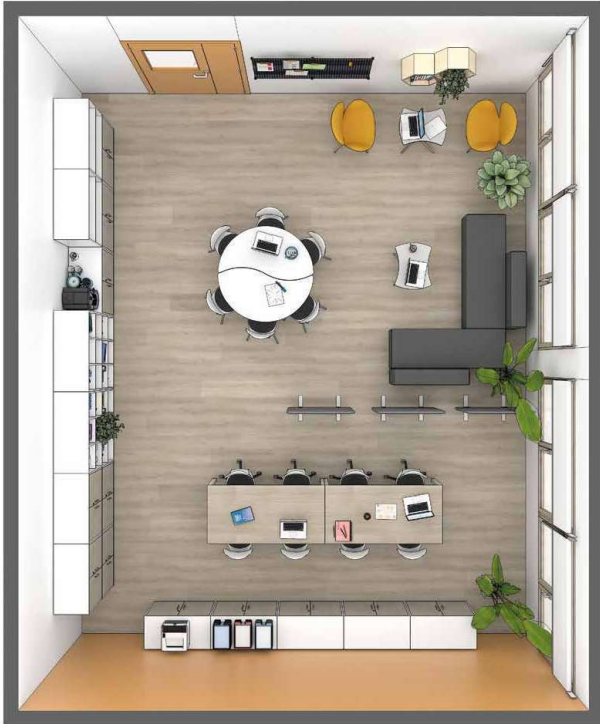

The place for reflection, assessment, content preparation and rest. The space for interaction between co-workers and meetings between tutors and students.

El lugar para la reflexión, la evaluación, la preparación de contenidos y el descanso. El espacio para la interacción entre compañeros de trabajo y las reuniones entre tutores y alumno.



50 m²



22





SAMOS

SAMOS dividers separate and isolate acoustically.

Los divisores SAMOS separan y aíslan acústicamente

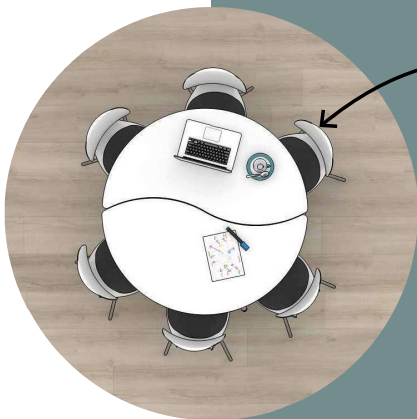

YANG

YANG tables to close the circle.

Mesas YANG para una mesa redonda



MULTIPURPOSE SPACES

Libraries shout: **Come!**

Libraries go from being a place where people just do research to become a place to go to feel more productive or to be close to friends and colleagues.

They become interdisciplinary, inclusive and inspiring learning spaces.

Las bibliotecas pasan de ser un lugar al que las personas van solo para investigar a un lugar que eligen visitar porque se sienten más productivos o quieren estar cerca de amigos y colegas.

Se convierten en espacios de aprendizaje interdisciplinarios, inclusivos e inspiradores.





Wellness feeling.





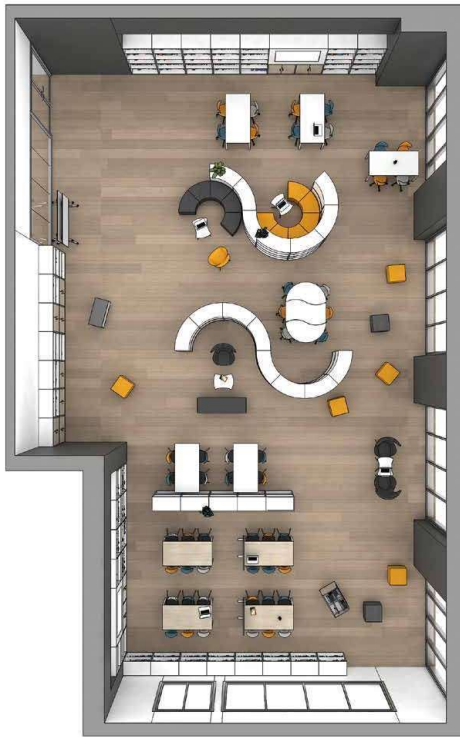

Libraries are at the intersection of academic, social and emotional needs. They become a meeting place where students can grow in many aspects.

Las bibliotecas se encuentran en la intersección de las necesidades académicas, sociales y emocionales. Se convierten en lugar de reunión donde los estudiantes pueden desarrollarse en múltiples dimensiones.



220 m²



75





Areas to sit and read as you would at home. Set of armchair and low table.

CHARLOTTE

Zonas para sentarse a leer como lo harías en casa. Conjunto de butacas y mesa baja.

LOUISE



Furniture with organic shapes that allows dividing spaces and create a comfort zone with sofas.

MARIE

Mobiliario de formas orgánicas que permite delimitar espacios y crear zona de confort con sofás.





Joan Jalencas

Sales Manager

Get together, meet, concentrate, explain, experiment, share, listen actively, etc., in different areas within the same educational, with versatile and mobile furniture, as well equipped as the mind is when learning.

Agruparse, reunirse, concentrarse, explicarse, experimentar, compartir, escuchar activamente... en un mismo espacio educativo con zonas diferenciadas, bien equipadas con mobiliario versátil y móvil. Tanto como lo es la mente cuando aprende.

Tips for corners



The MARIE curved cabinet surrounds a space that, together with the ANGLE sofa, invites to meet in small groups to debate.

El armario en curva MARIE recoge un espacio que con el sofá ANGLE invita a reunirse en pequeños grupos para debatir.

The double-height MARIE curved cabinet creates an interior space that enables a quiet work area with a large table.

El armario en curva MARIE en doble altura crea un espacio interior que habilita una zona de trabajo tranquila con una amplia mesa.



The CHARLOTTE armchair, with its wraparound seat, leads to internalisation, calm and meditation.

La butaca CHARLOTTE, asiento envolvente, conduce a la interiorización, la calma y la meditación.



CANTEEN

Much more than eating

Eating is a basic need. So are socializing, enjoying, savouring, learning, sharing, relaxing and nourishing oneself internally and externally.

Alimentarse es una necesidad. Socializar, disfrutar, saborear, aprender, compartir, descansar y nutrirse por dentro y por fuera, también.





Meeting point.

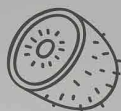



Mirple
School



As at home, where kitchen becomes the nerve centre where life happens, we can turn the canteen into something more than just a place to eat. The wood finishes, the organic colors and the design aiming to offer comfort are the key.

Como ocurre en un hogar, donde la cocina acaba siendo el punto neurálgico donde se desarrolla la vida, podemos conseguir que la cantina se habite para mucho más que para solo comer. Los acabados de madera, los colores orgánicos y el diseño pensado para ofrecer confort y comodidad, son la clave.



108 m²



48





LUCA

The LUCA chair is stackable, easy to clean and maintain.

La silla LUCA es apilable, fácil de mantener y limpiar.



IRENE

The IRENE cabinet with its wooden doors brings warmth to the canteen and helps keep the space tidy and clean.

El armario IRENE con sus puertas de madera aporta calidez al comedor y ayuda a mantener el espacio ordenado y limpio.



EARLY AGES

Sensory experimentation

A classroom with different corners where symbolic play can be developed and sensory stimulation favored by manipulating different objects that are the center of interest for the little ones.

Un aula con diferentes rincones donde desarrollar el juego simbólico y favorecer la estimulación sensorial con la manipulación de diferentes objetos que son centro de interés de los más pequeños.



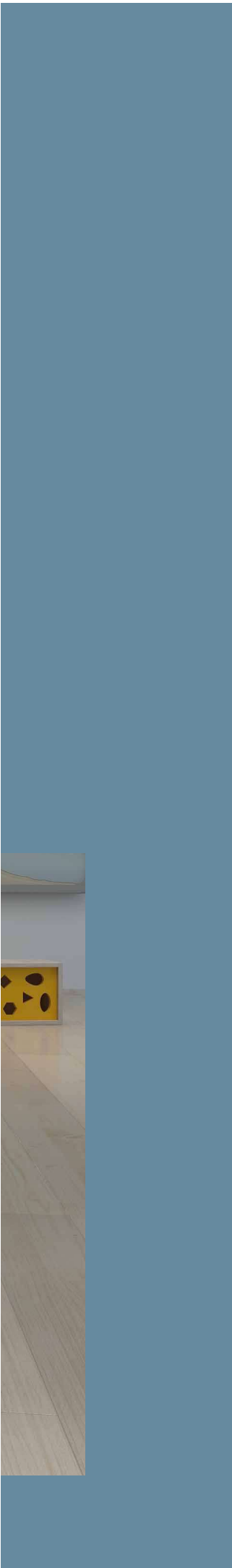

The living classroom.





$2+2=4$
 $3 \times 5 = 9$
123

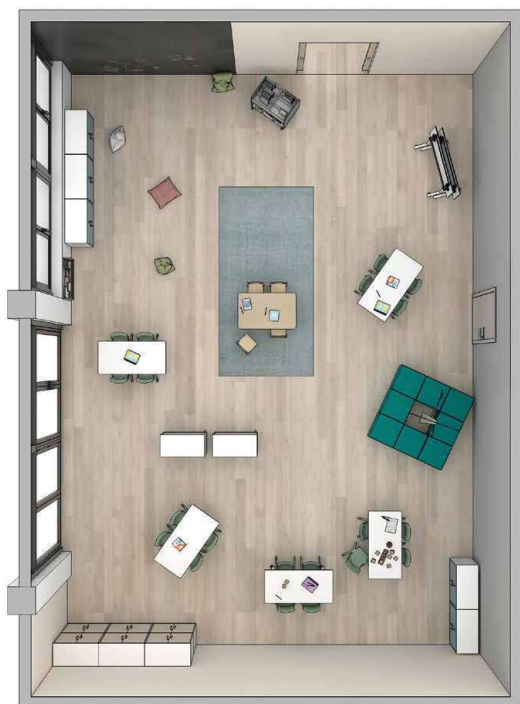

Classrooms where different educational dynamics coexist simultaneously, where the little ones move, group and ungroup to experiment, rest, play.

Aulas en las que conviven simultáneamente diferentes dinámicas educativas, donde los más pequeños se mueven, agrupan y desagrupan para experimentar, descansar, jugar.



100 m²



25





TEO

The wood in tables (TEO) and chairs (ZOE) brings warmth and comfort to the classroom.

La madera en mesas (TEO) y sillas (ZOE) aporta calidez y confort al aula.

ZOE



HEDY

The HEDY cabinet on castors allows you to comfortably and dynamically separate spaces.

El armario con ruedas HEDY permite separar espacios cómodamente y de forma dinámica.

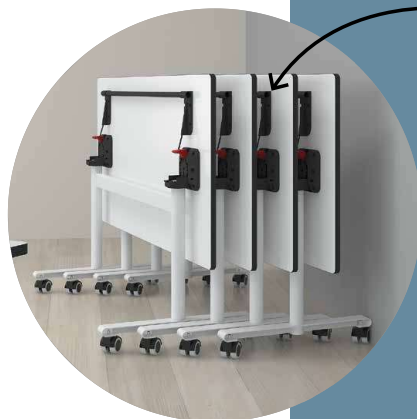

MINIFLOOP

The MINIFLOOP tables are folding and allow you to quickly transform a workspace into an open space to play or rest.

Las mesas MINIFLOOP son abatibles y permiten transformar rápidamente un espacio de trabajo en uno diáfano para jugar o descansar.



*Montessori-inspired
classroom.*





A modular classroom in which cooperative work is the core and the child the protagonist of their experience and learning. With tables that allow various configurations to expand the multiple intelligences.

Un aula modular en la que el trabajo cooperativo es el eje y el niño el protagonista de su experiencia y aprendizaje. Con mesas que permiten diversas configuraciones donde expandir las múltiples inteligencias.



40 m²



25





MIA MINILIFT

The MIA MINILIFT chair for adults adapts to the height of children's tables for greater comfort for teachers and students.

La silla MIA MINILIFT para adulto se adapta a la altura de las mesas infantiles para un mayor confort de docentes y alumnos.

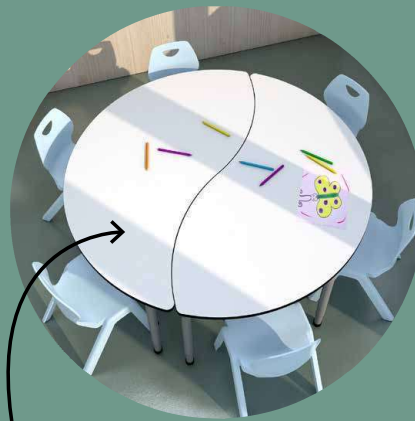

MIA MINILIFT

The YANG table allows you to quickly create round tables and also different configurations.

La mesa YANG permite crear mesas redondas y diferentes encajes ágilmente.



*The importance
of order.*



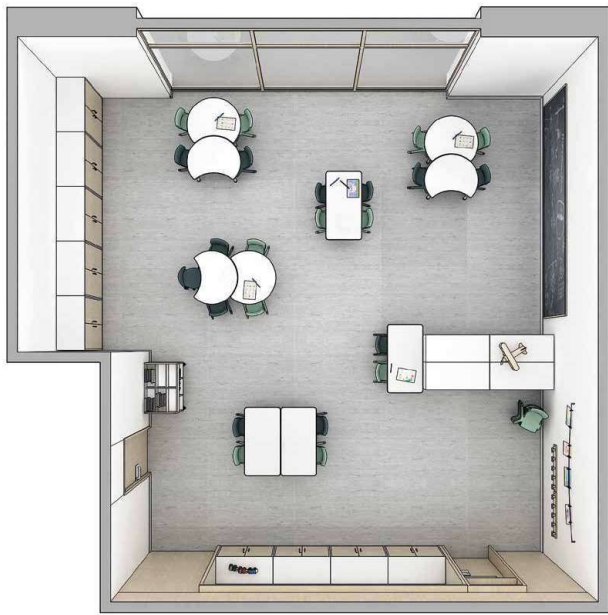

Storage in the classroom favors both spatial and mental order. Tables and cabinets that, with their design, colour and resistance to shocks and water, favor visual and experiential harmony in the classroom.

El almacenaje en el aula para disponer el material favorece el orden del espacio y el mental. Mesas y armarios que, con su diseño, cromatismo y resistencia a los golpes y al agua, favorecen la armonía visual y experiencial en el aula.



60 m²



25





GRACE

The GRACE cabinet with trays in two sizes, guided by rails to prevent them from coming out of the cabinet.

El armario GRACE con bandejas de dos tamaños, sujetas por railes para evitar que se salgan del mueble.



RONY

The RONY table has adjustable legs at different heights for the comfort of all.

La mesa RONY tiene las patas ajustables a diferentes alturas para comodidad de todos.

Chairs

Reconcile with the movement.
Chairs that facilitate grouping and ungrouping quickly and without noise, that promote order and prioritize dynamic comfort. Chairs not only designed for sitting down.

Reconciliarse con el movimiento.
Sillas que facilitan el agruparse y desagruparse ágilmente y sin ruidos, que favorecen el orden y priorizan un confort dinámico. Sillas no solo pensadas para el momento de sentarse.





JON

Ref. 1045



SIZE

(+info P. 193)

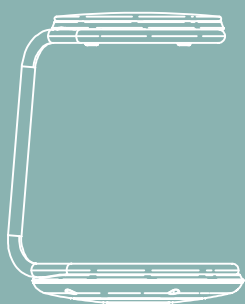

53,5 CM

7

DETAILS



JON



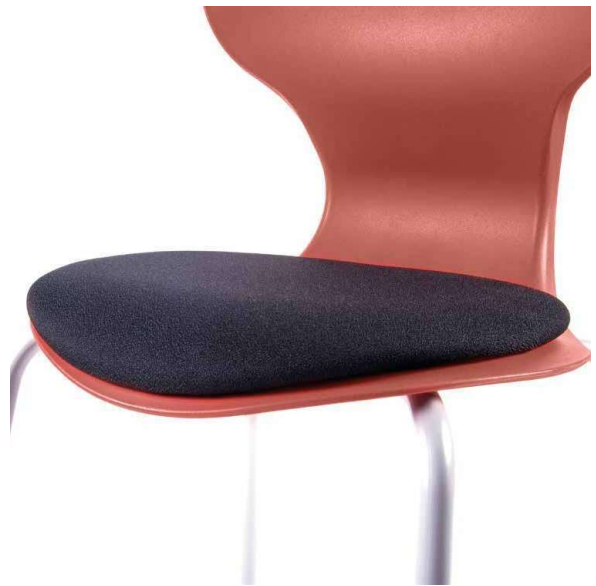



MIA



MIA BASIC



MIA CANTILEVER



MIA CASTORS



MIA MINI LIFT



MIA LIFT



MIA BIG LIFT



MIA STOOL



MIA STORE



MIA TABLE





MIA BASIC

Ref. 1028



SIZE

(+info P. 193)

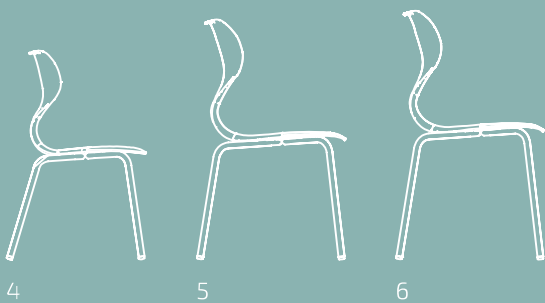

OPTIONS



DETAILS



MIA CANTILEVER

Ref. 1027



SIZE

(+info P. 193)



5



6

OPTIONS



DETAILS





MIA CASTORS

Ref. 1029



SIZE

(+info P. 193)



4



5



6

OPTIONS



DETAILS



MIA MINI LIFT

Ref. 169



SIZE

(+info P. 193)

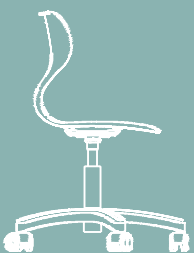

31-41 CM

DETAILS





MIA LIFT

Ref. 1035



SIZE

(+info P. 193)

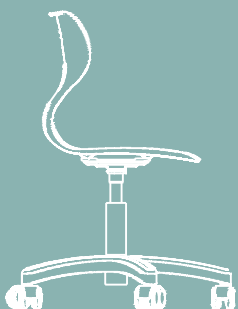

40-51 CM

OPTIONS



DETAILS



MIA BIG LIFT

Ref. 1039



SIZE

(+info P. 193)

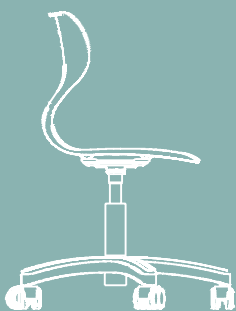

40-51 CM

OPTIONS





MIA STOOL

Ref. 1030



SIZE

(+info P. 193)

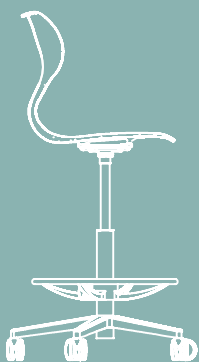

58-83 CM

OPTIONS



DETAILS



MIA STORE

Ref. 1038



SIZE

(+info P. 193)



6

OPTIONS



DETAILS





MIA TABLE

Ref. 1036



SIZE

(+info P. 193)

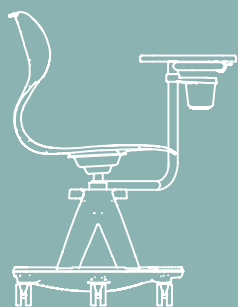

57X33 CM

6

OPTIONS



DETAILS





360°



How does it work? Watch the video here:
¿Cómo funciona? Mira el vídeo aquí:





ZTOOL

Ref. 1020



ZTOOL TROLLEY

Ref. 1037



X 40 ZTOOL



YouTube



How does it work? Watch the video here:

¿Cómo funciona? Mira el vídeo aquí:



SIZE
(+info P. 193)

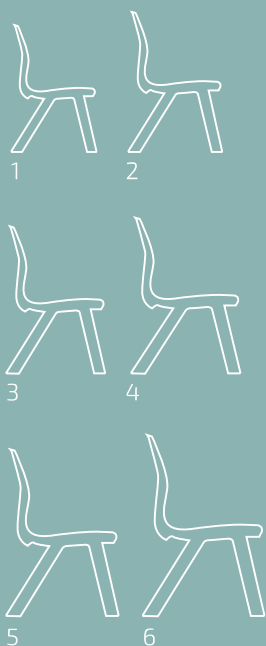

INA

Ref. 147

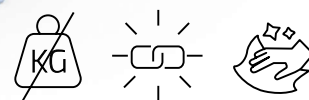

SIZE
(+info P. 193)

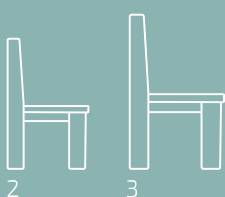

DETAILS | DETALLES



ZOE

Ref. 1044



Soft seating

Socialize, share and relax.
Soft seating furniture allows you to create a space for impromptu conversations and allows you to bring life to areas of the educational centre that have not been used until now.

Socializar, compartir y relajarse.
El mobiliario soft seating permite crear un espacio para conversaciones improvisadas y permite dar vida a zonas del centro educativo hasta ahora desaprovechadas.







CHLOE

Ref. CHLOE

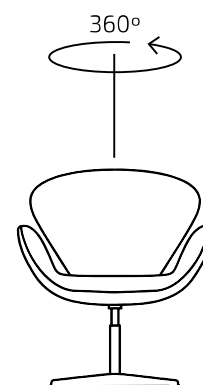

SIZE

69 CM

67 CM



79 CM

44 CM

DETAILS



CHARLOTTE

Ref. 1041

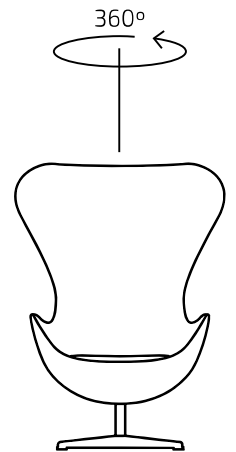

SIZE

82 CM

77 CM



108 CM



42 CM

DETAILS





ANGLE

Ref. 12001

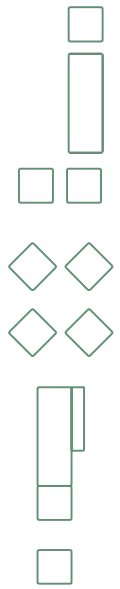

CUBE

Ref. 12002



SIZE

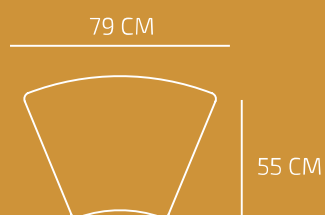

SIZE

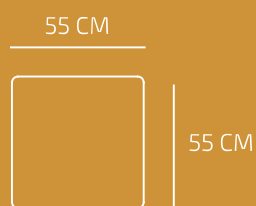

DETAILS





TUBE

Ref. 12003

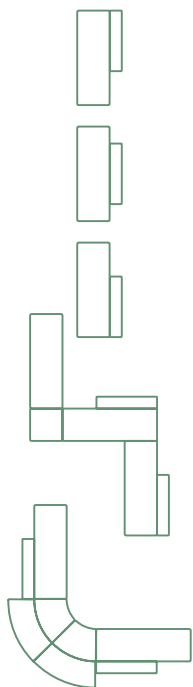
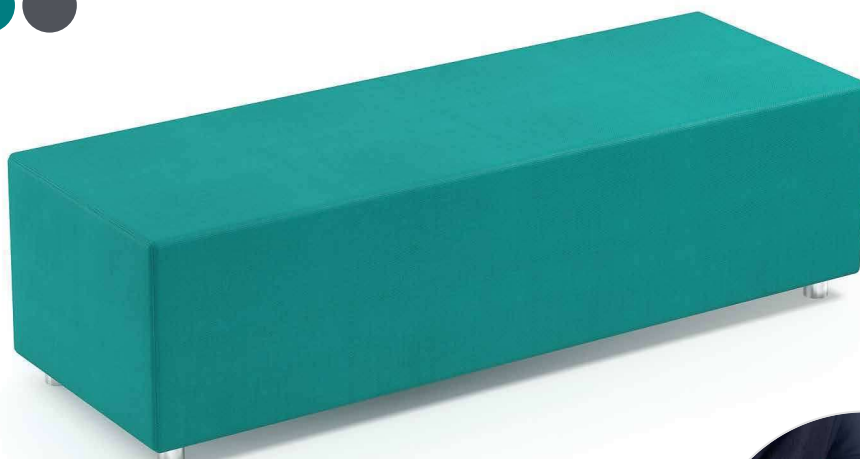

COMPLETE SOFA

Ref. 12005

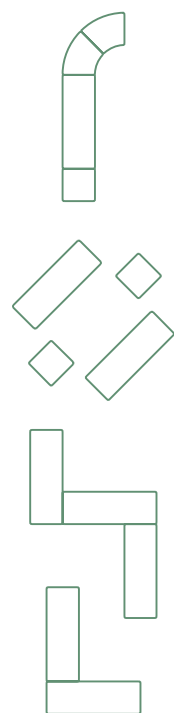

SIZE

160 CM

55 CM

75 CM

55 CM

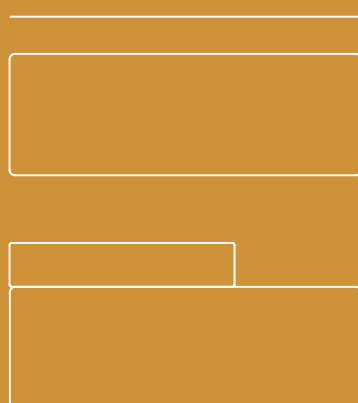

DETAILS





MOVE

Ref. 1608



Easy to move



SIZE

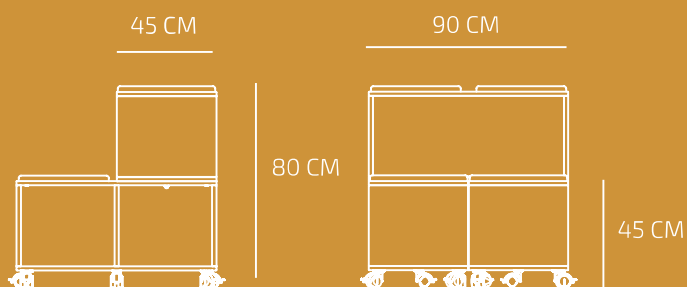

DETAILS



MINI MOVE

Ref. 1609



Easy to move



SIZE

45 CM

90 CM



45 CM

DETAILS



Tables

Work platforms. Tables that allow classrooms to be quickly configured and adapted for collaborative work. With height-adjustable, mobile, easy to fit and storable designs to quickly facilitate the execution of any task.

Plataformas de trabajo. Mesas que permiten configurar y adaptar las aulas ágilmente para el trabajo colaborativo. Con diseños ajustables en altura, móviles, encajables y almacenables para facilitar rápidamente la ejecución de cualquier tarea.

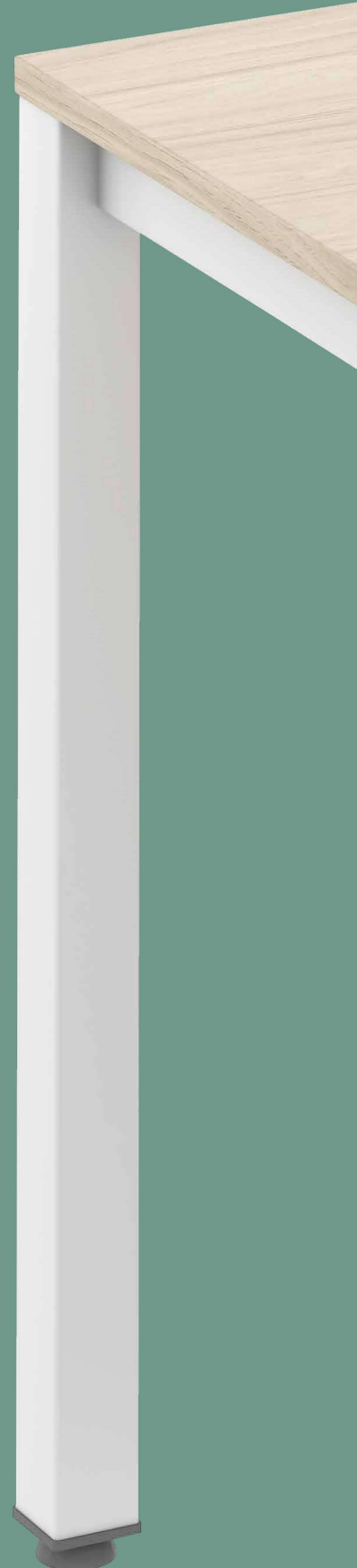



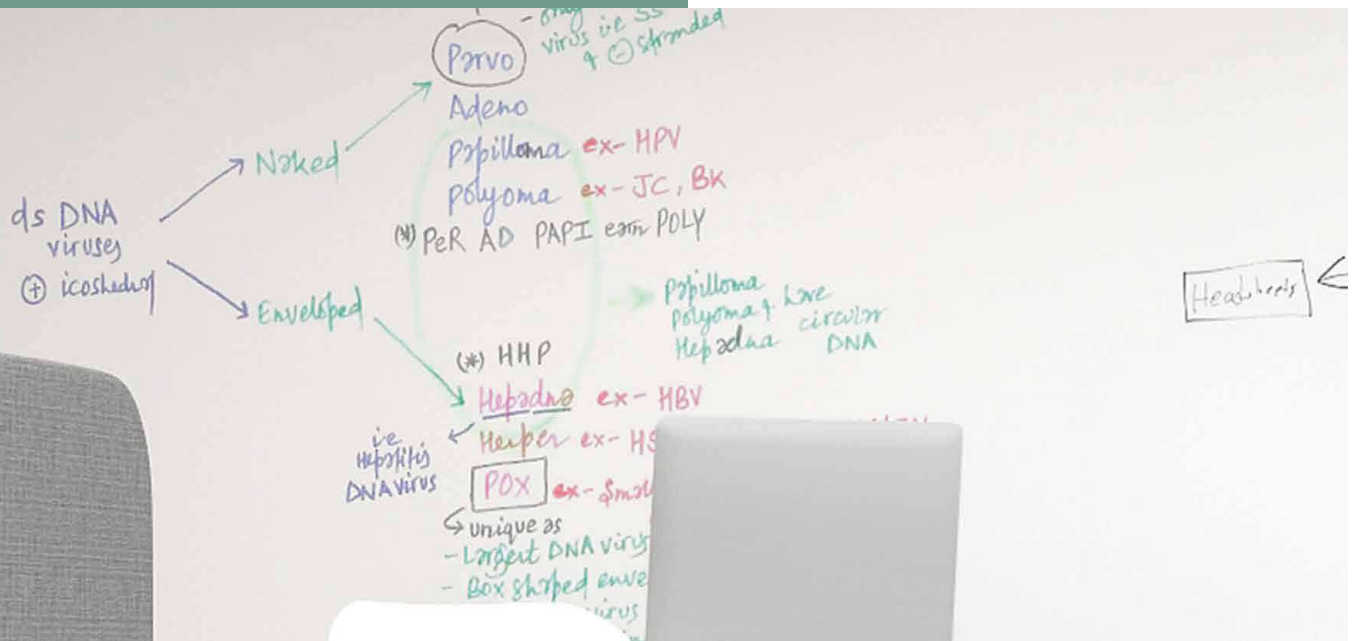

Headrest ←



MOON

Ref. 2362



MAX.
H 102 cm



MIN.
H 73 cm



SIZE

(+info P. 193)

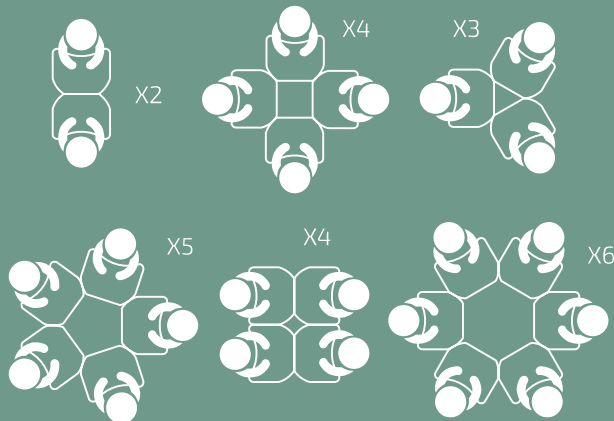

DETAILS





SQUARE

Ref. 2341IN



SIZE

(+info P. 193)



DISTRIBUTION



COMBINATIONS

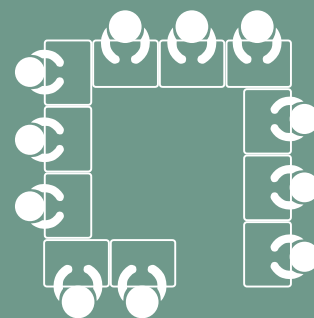
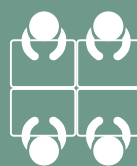

ARROW

Ref. 2329IN



Injected PP edge



SIZE

(+info P. 193)

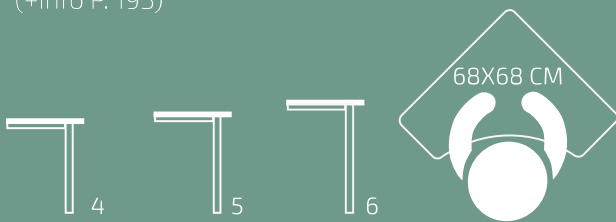

COMBINATIONS

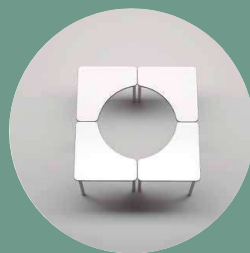

DISTRIBUTION

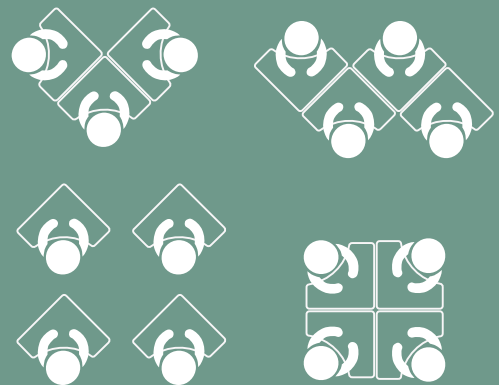



HEXA

Ref. 2336IN

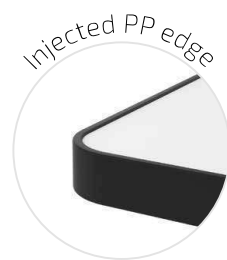

SIZE

(+info P. 193)

72X50 CM



4



5



6



COMBINATIONS

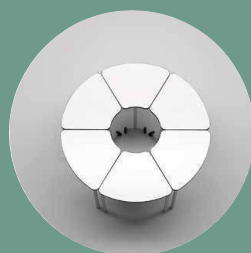

DISTRIBUTION



Ø 150 cm



OCTA

Ref. 2335IN



Injected PP edge

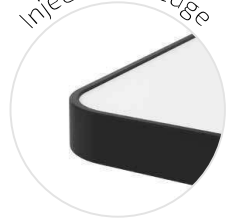

OPTIONAL



SIZE

(+info P. 193)

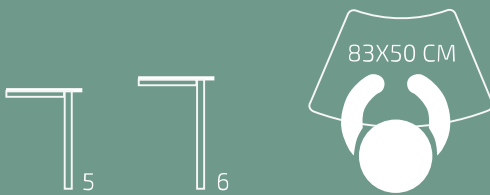

COMBINATIONS

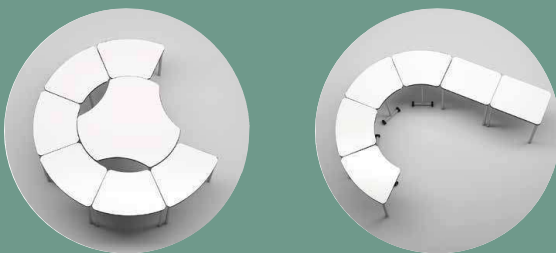

DISTRIBUTION

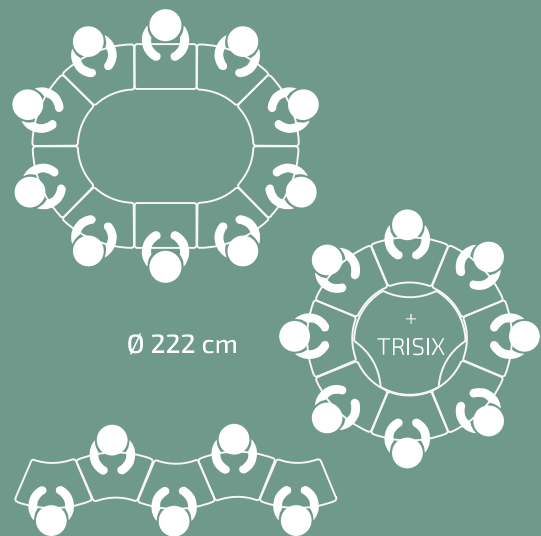



YANG

Ref. 2345RC (1-3)
Ref. 2345R (4-6)



1-3



4-6

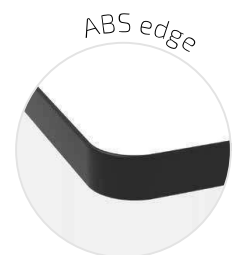

SIZE

(+info P. 193)

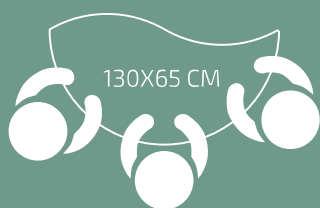

DISTRIBUTION

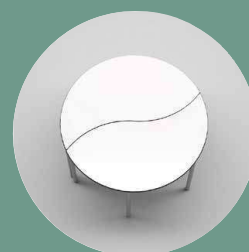
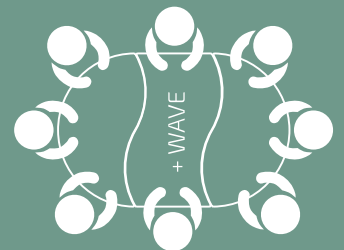
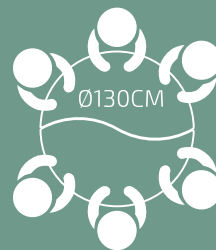

WAVE

Ref. 2344RC (1-3)

Ref. 2344R (4-6)



1-3



4-6

ABS edge



SIZE

(+info P. 193)

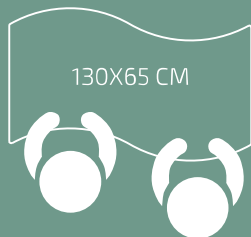

DISTRIBUTION

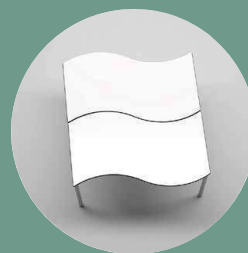
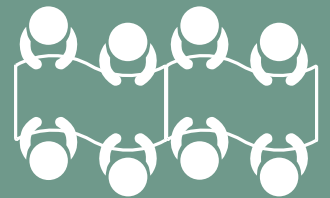



TRISIX

Ref. 2346RCIN (1-3)
Ref. 2346IN (4-6)



1-3



4-6



SIZE

(+info P. 193)



DISTRIBUTION

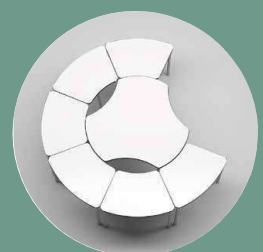
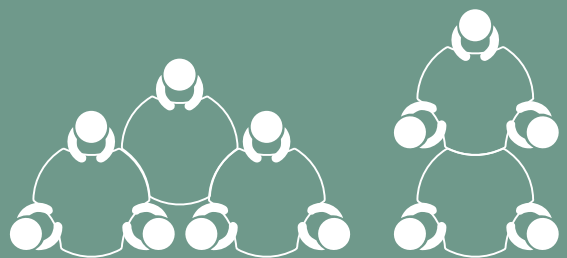





RECTANGLE

Ref. 2352-3 (1-3)
Ref. 2352-6 (4-6)



1-3



4-6

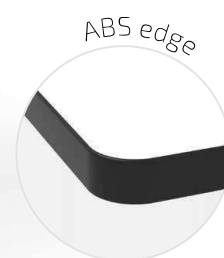

SIZE

(+info P. 193)

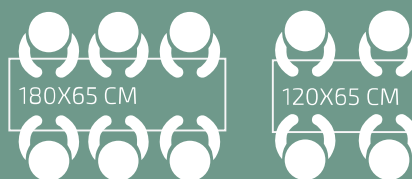

SIZE

(+info P. 189)

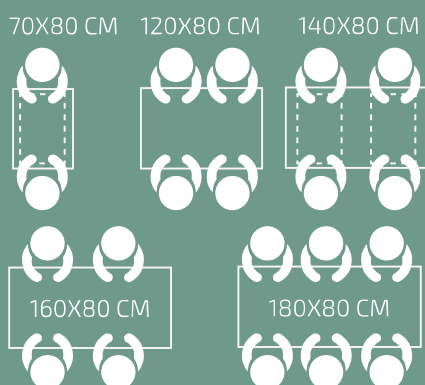

RECTANGLE PLUS

Ref. 2353-8



ABS edge



SIZE

(+info P. 193)





RECTANGLE TEACHER

Ref. 2355D



SIZE

(+info P. 193)



120X65 CM





NAXEL

Ref. 620

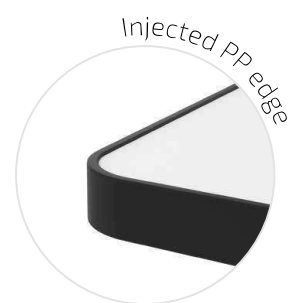

SIZE

(+info P. 193)







SPACE DESIGN

Ref. 261



OPTIONS



SIZE

(+info P. 193)

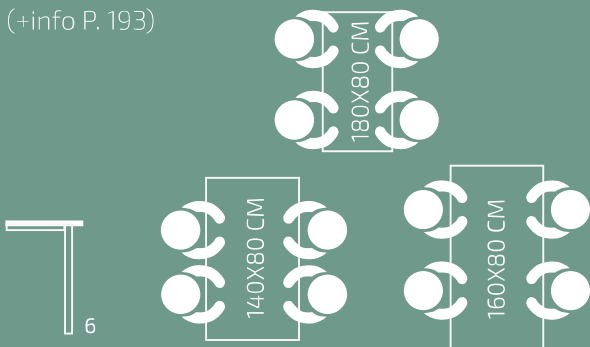

DETAILS



OPTIONS





SPACE PLUS

Ref. 260



SIZE

(+info P. 193)



DETAILS







ALUFLOOP

Ref. 2048R



ABS edge

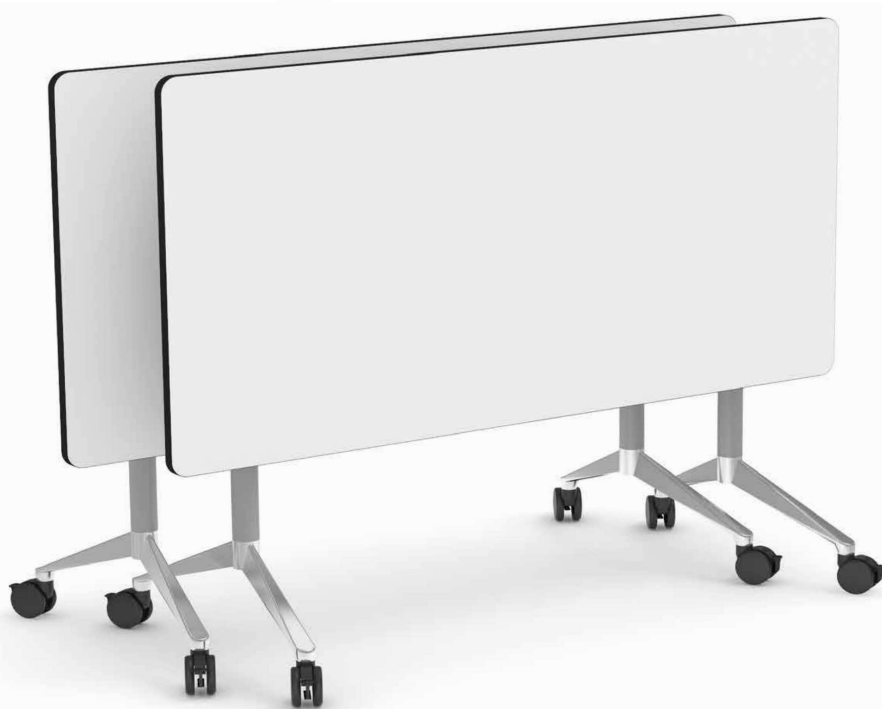
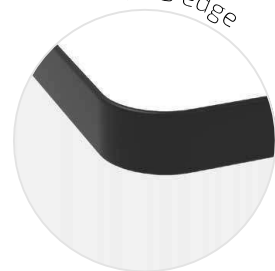

SIZE

(+info P. 193)

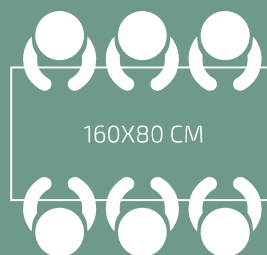
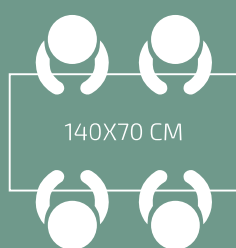

MINIFLOOP

Ref. Z261DNR

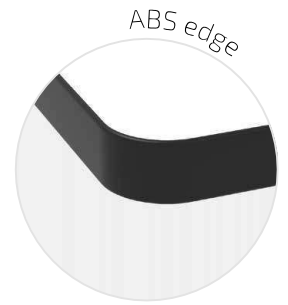

SIZE

(+info P. 193)



1



2



3



4

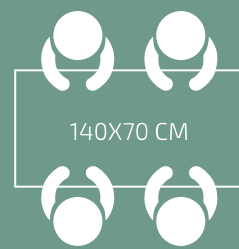

140X70 CM



LOUISE

Ref. 2354



H 47 CM



H 70 CM



360°

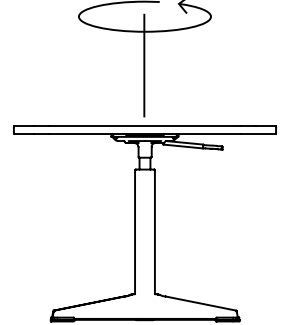

SIZE

(+info P. 193)

66 CM



52 CM

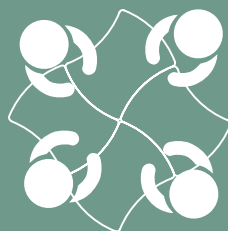

DETAILS





RONY

Ref. 2221 - 2220



SIZE

(+info P. 193)



OPTIONS

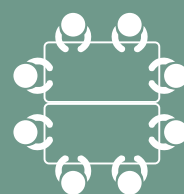
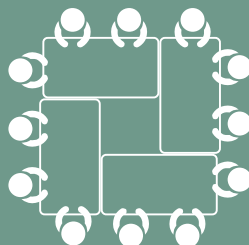
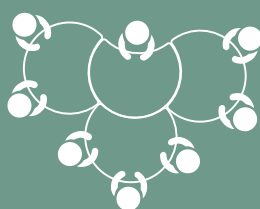





TEO

Ref. 2368



SIZE

(+info P. 193)



DETAILS



Acoustic

Making the classroom experience better. Acoustic panels and dividers absorb sound, reduce reverberation and improve intelligibility, well-being, concentration and speech performance in classrooms.

Mejorar la experiencia en el aula. Los paneles y separadores acústicos absorben el sonido, reducen la reverberación y mejoran la inteligibilidad, el bienestar, la concentración y el rendimiento del habla en las aulas.





ARA

Ref. 2106-625



SIZE

62,5 X 62,5 CM

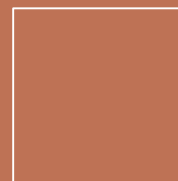

DETAILS

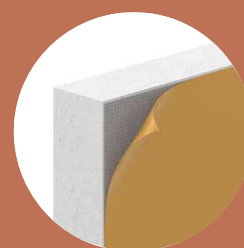

LEDA

Ref. 2106-625



SIZE

62,5 X 62,5 CM

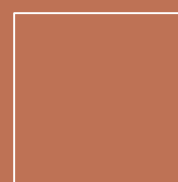

DETAILS

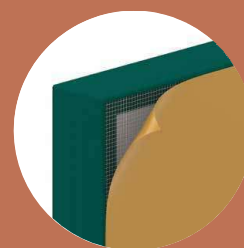

SIZE

62,5 X 120 CM

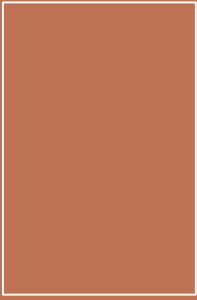

OPTIONS

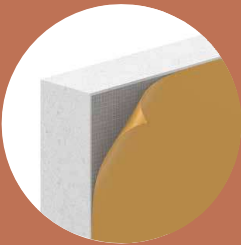

CERES

Ref. 2106-1200



SIZE

62,5 X 120 CM

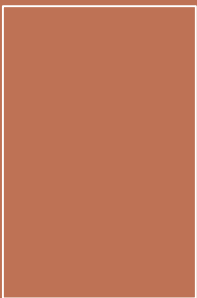

OPTIONS

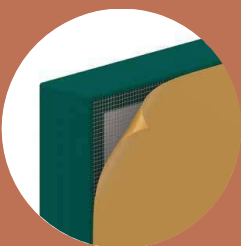

MENSA

Ref. 2106-1200

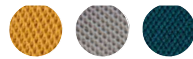



SAMOS

Ref. 2104

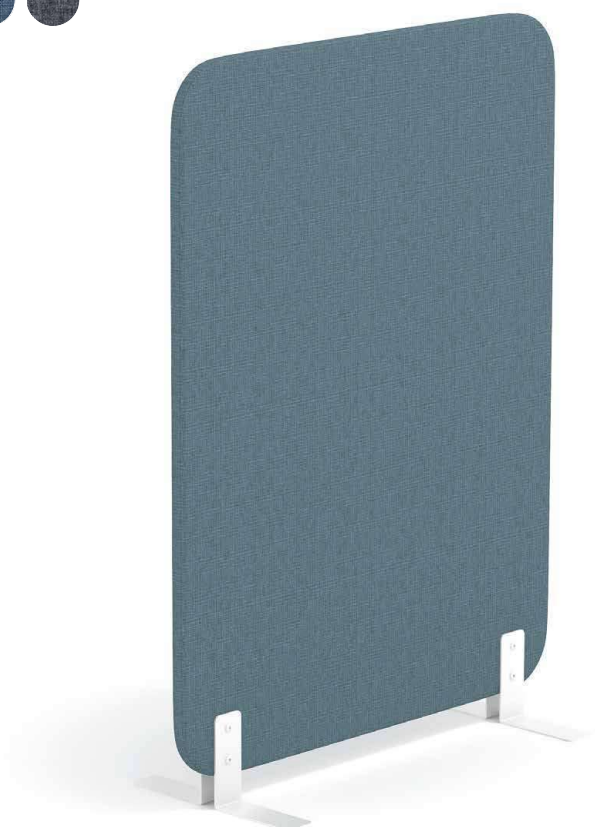

SIZE

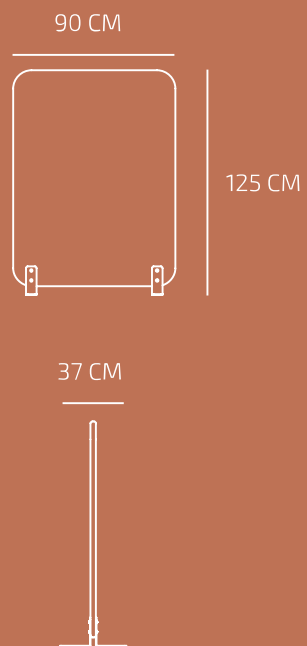

ELEA

Ref. 2105



SIZE

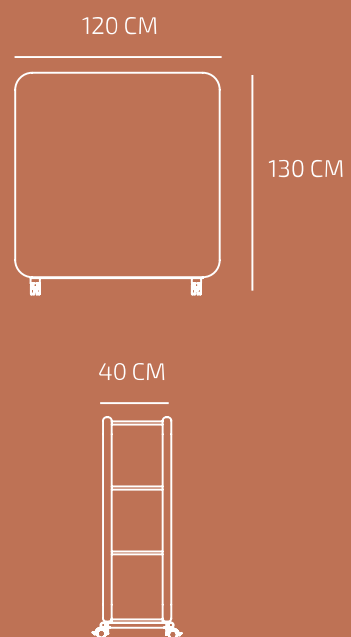





AURE S

Frame



Interior panel



Wall panel exterior



INSIDE FURNITURE INCLUDED

SIZE

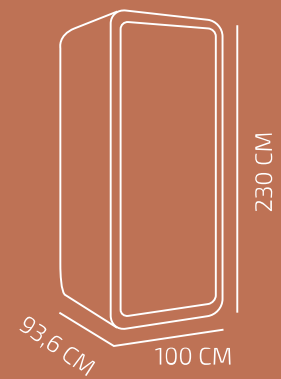

AURE M

Frame



Interior panel



Wall panel exterior



INSIDE FURNITURE INCLUDED

SIZE

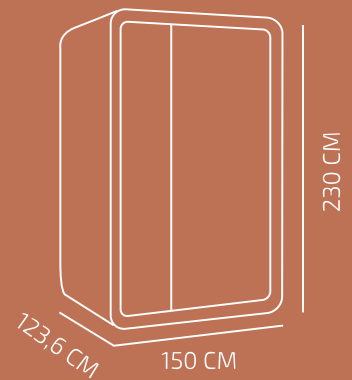

AURE L

Frame



Interior panel



Wall panel exterior



INSIDE FURNITURE INCLUDED

SIZE

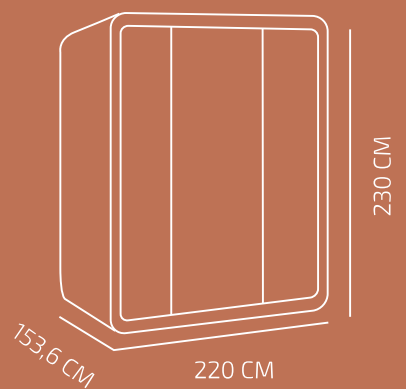



Mirplay

Cabinets

Everything in its place.

Each educational space and classroom have their specific requirements for learning material and distribution. Cabinets are a key element designed to facilitate the different dynamics and the order that each classroom needs.

Todo en su sitio.

Cada espacio educativo y cada aula tiene sus requerimientos específicos de material de aprendizaje y distribución. Los armarios son un elemento clave diseñado para facilitar las diferentes dinámicas y el orden que cada aula necesita.

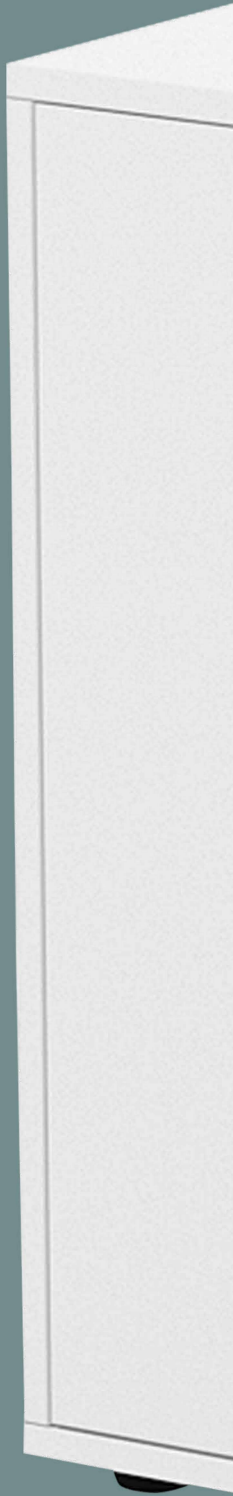





H 80cm



MARIE

Ref. 732-601



HEDY

Ref. 532-501



ADA

Ref. 532-502



JANE

Ref. 632-504

H 120cm



IRENE

Ref. 533-501



EMMY

Ref. 533-502



ANNIE

Ref. 633-507



SOPHIE

Ref. 633-501

H 160cm



MILEVA

Ref. 534-501



FLORA

Ref. 534-508



INGE

Ref. 534-509



ELSA

Ref. 634-508

H 200cm



EMILIE

Ref. 535-501



MAUD

Ref. 535-508



ROSIE

Ref. 535-521



MERIT

Ref. 632-507



GRACE

Ref. 632-501



ALICE

Ref. 634-510



DAN

Ref. 551

COLOURS



DETAILS



OPTIONS





MARIE

Ref. 732-601

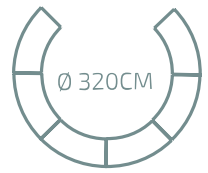

SIZE

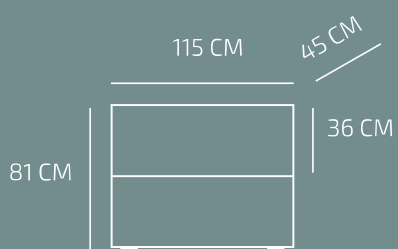

OPTIONS



COMBINATIONS



HEDY

Ref. 532-501



ADA

Ref. 532-501



SIZE

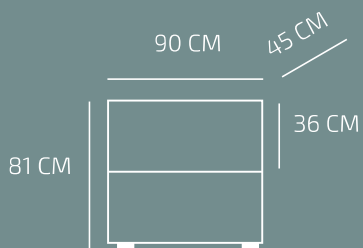

OPTIONS



DETAILS



JANE

Ref. 632-504



SIZE

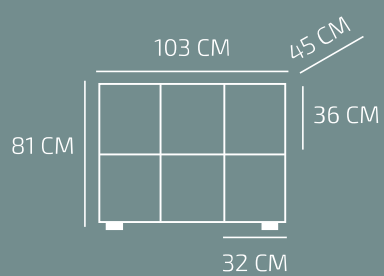

OPTIONS



MERIT

Ref. 632-507

Ref. 632-508



 x 9



 x 12



SIZE

Ref. 632-507

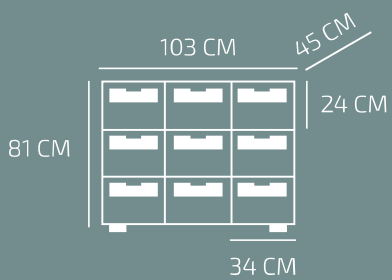

Ref. 632-508

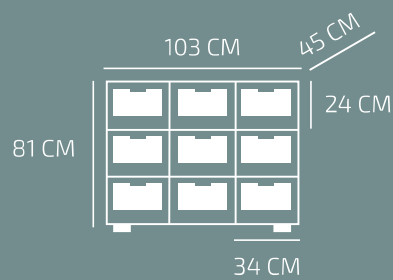

OPTIONS





GRACE

Ref. 632-501

Ref. 632-503



 x 21



 x 12



SIZE

Ref. 632-501

Ref. 632-503

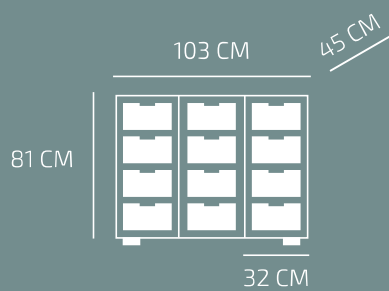
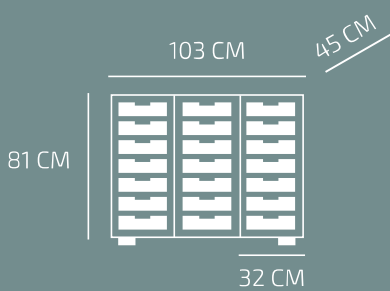

OPTIONS







IRENE

Ref. 533-501



EMMY

Ref. 533-502



SIZE

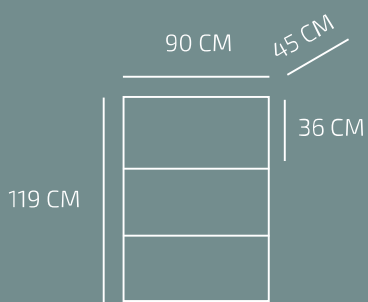

OPTIONS



DETAILS





ANNIE

Ref. 633-507

Ref. 633-509



 x15



 x15



SIZE

Ref. 633-507

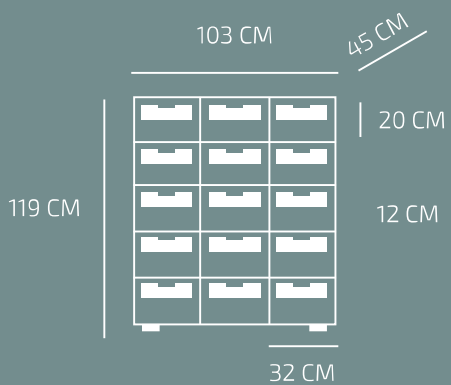

Ref. 633-509

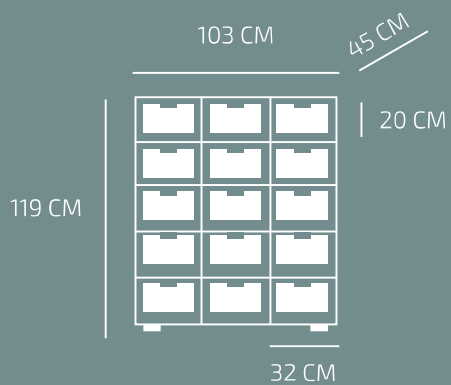

SOPHIE

Ref. 633-501

Ref. 633-503



x33



x18



SIZE

Ref. 633-501

Ref. 633-503

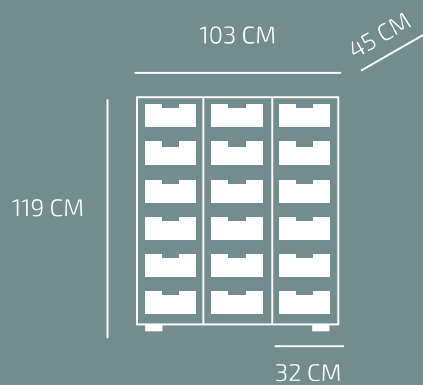
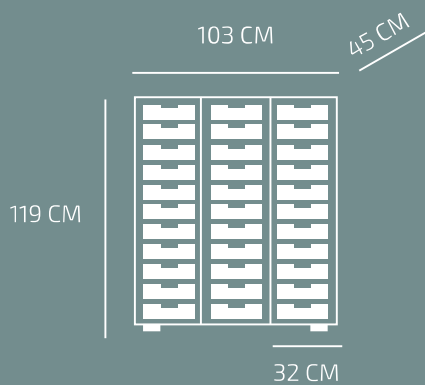



MILEVA

Ref. 534-501



FLORA

Ref. 534-508





INGE

Ref. 534-509



SIZE

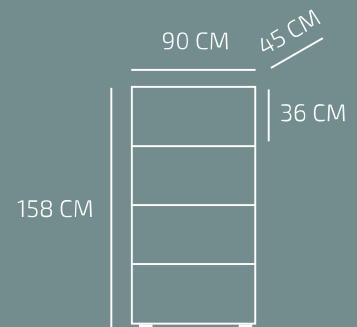

OPTIONS





ELSA

Ref. 634-508



SIZE

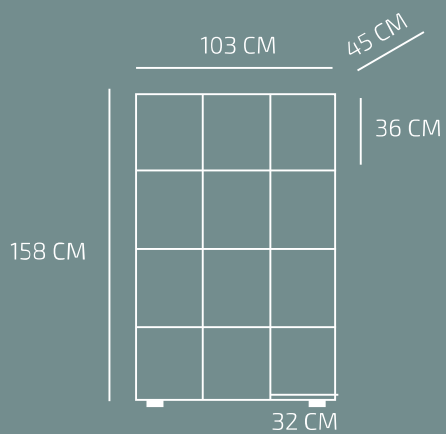

ALICE

Ref. 634-510

Ref. 634-512



 x 21



 x 12



SIZE

Ref. 634-510

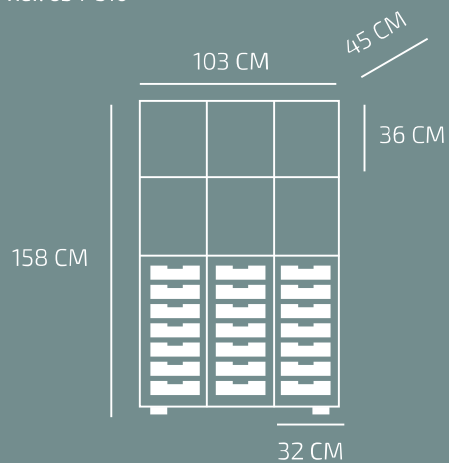

Ref. 634-512

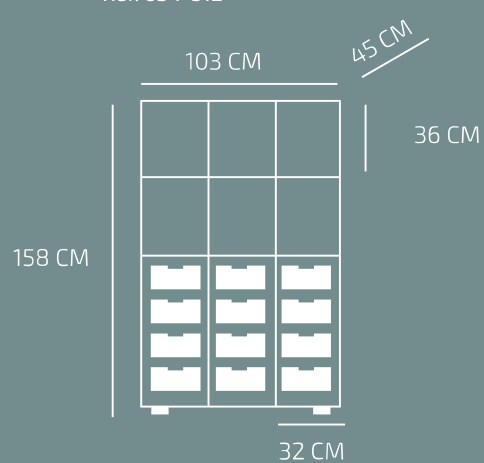



EMILIE

Ref. 535-501



MAUD

Ref. 535-508





ROSIE

Ref. 535-521



SIZE

90 CM

45 CM

196 CM

36 CM

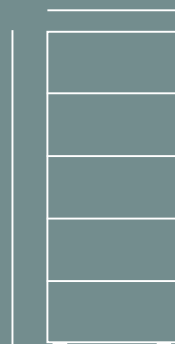

OPTIONS





DAN

Ref. 551



SIZE

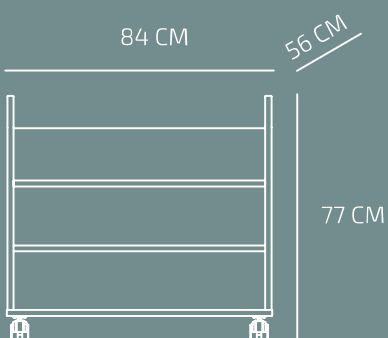

DETAILS





Complements

For a smoother experience.
Support tools designed to facilitate
collaborative learning dynamics and a fluid
and orderly cohabitation in the classroom.

Para una experiencia más fluida.
Herramientas de apoyo pensadas para facilitar
las dinámicas de aprendizaje colaborativo y
una fluida y ordenada convivencia en el aula.



CONNECTIONS

CONCEPTS

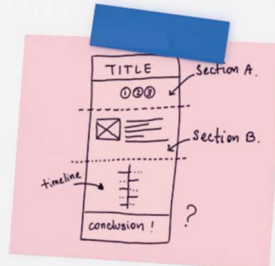
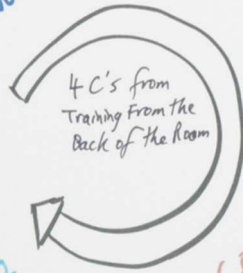

NOVEMBRE						
DL	DM	VE	VI	SV	SA	SD
	1	2	3	4	5	6
7	8	9	10	11	12	13
14	15	16	17	18	19	20
21	22	23	24	25	26	27
28	29	30				

MARS						
DL	DM	VE	VI	SV	SA	SD
	1	2	3	4	5	
6	7	8	9	10	11	12
13	14	15	16	17	18	19
20	21	22	23	24	25	26
27	28	29	30	31		

KEY ^{Concept} LEARNINGS

RELATE TO WORK

CONCLUSIONS

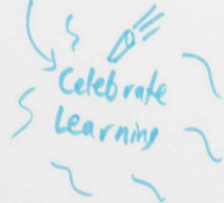

CONCRETE PRACTICE

→ Active Participation

→ Collaborative Interdependence





SIZE

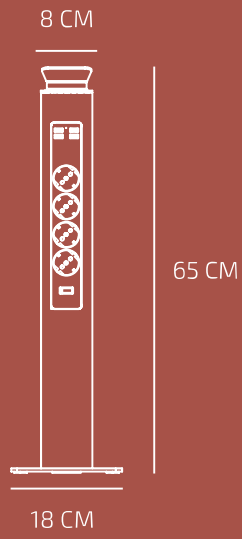

DETAILS



ODON



SIZE

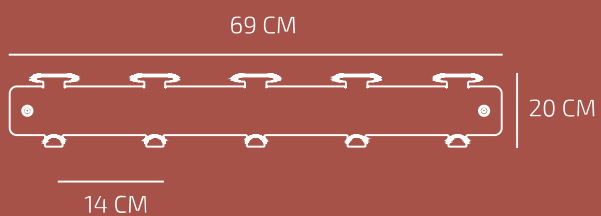

MARCUS

Ref. 7028



SIZE

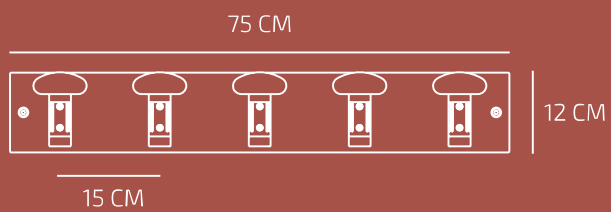

PEGGY

Ref. 751





LILY

Ref.4001



SIZE

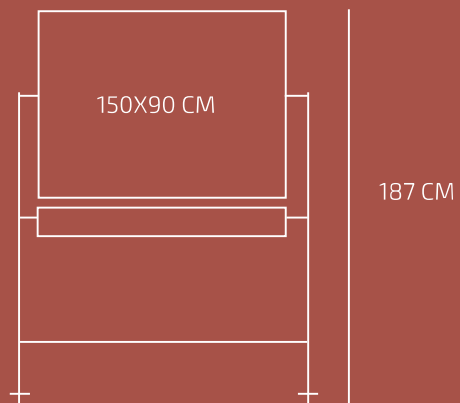

DETAILS



MINI LILY

Ref. 4002



Ref. 7029



SIZE

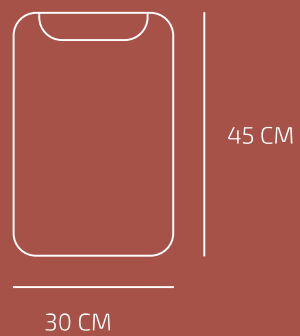

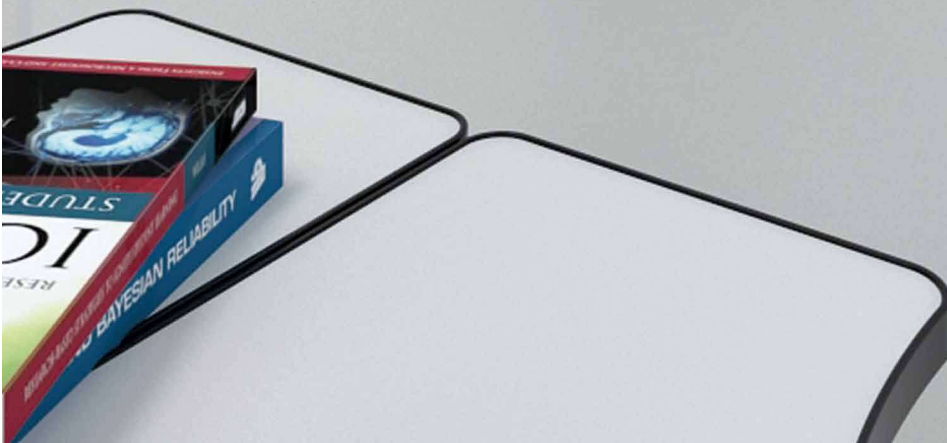

JON
1045



p. 94

MIA BASIC
1028



p. 98

MIA CANTILEVER
1027



p. 99

MIA CASTORS
1029



p. 100

MIA MINI LIFT
169



p. 101

MIA LIFT
1035



p. 102

MIA BIG LIFT
1039



p. 103

MIA STOOL
1030



p. 104

MIA STORE
1038



p. 105

MIA TABLE
1036



p. 106

ZTOOL
1020



p. 108

ZTOOL TROLLEY
1037



p. 108

INA
147-1/2/3/4/5/6

p. 111



ZOE
1044



p. 111

CHLOE



p. 114

CHARLOTTE
1041



p. 115

ANGLE
12001



p. 116

CUBE
12002



p. 116

TUBE
12003



p. 117

COMPLETE SOFA
12005



p. 117

MOVE
1608



p. 118

MINI MOVE
1609



p. 119

MOON
2362



p. 123

SQUARE
2341IN



p. 124

ARROW
2329IN



p. 125

HEXA
2336IN



p. 126

OCTA
2335IN



p. 127

YANG
2345R



p. 128

WAVE
2344R



p. 129

TRISIX
2346IN



p. 130

RECTANGLE
2352



p. 132

RECTANGLE PLUS
2353



p. 133

RECTANGLE TEACHER
2355D



p. 135

NAXEL
620



p. 136

SPACE DESIGN
261



p. 139

SPACE PLUS
260



p. 140

ALUFLOOP
2048R



p. 142

MINIFLOOP
226DNR



p. 143

LOUISE
2354



p. 145

RONY
2221



p. 146

RONY
2220



p. 146

TEO
2368



p. 149

ARA
2106-625

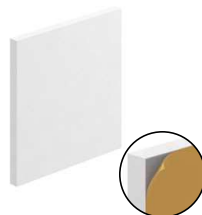

p. 152

LEDA
2106-625

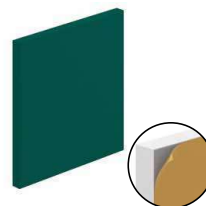

p. 152

CERES
2106-1200

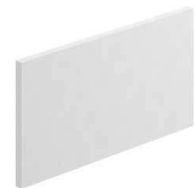

p. 153

SAMOS
2104



p. 154

ELEA
2105



p. 154

AURE S



p. 156

AURE M



p. 156

AURE L



p. 156

MARIE
732-601



p. 162

HEDY
532-501



p. 163

ADA
532-502



p. 163

JANE
632-504



p. 164

MERIT
632-507



p. 165

MERIT
632-508



p. 165

GRACE
632-501



p. 166

GRACE
632-503



p. 166

IRENE
533-501



p. 169

EMMY
533-502



p. 169

ANNIE
633-507



p. 170

ANNIE
633-509



p. 170

SOPHIE
633-501



p. 171

SOPHIE
633-503



p. 171

MILEVA
534-501



p. 172

FLORA
534-508



p. 172

INGE
534-509



p. 173

ELSA
634-508



p. 174

ALICE
634-510



p. 175

ALICE
634-512



p. 175

EMILIE
535-501



p. 176

MAUD
535-508



p. 176

ROSIE
535-521



p. 177

DAN
551



p. 178

ODON



p. 182

MARCUS
7028



p. 183

PEGGY
751



p. 183

LILY
4001



p. 184

MINI LILY
4002



p. 184

MINI LILY HOOK
7029



p. 184



Size

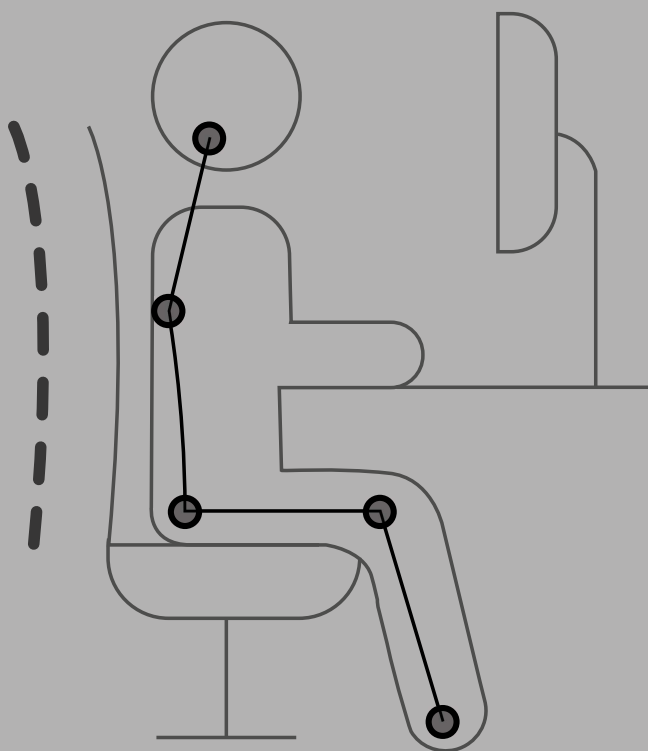

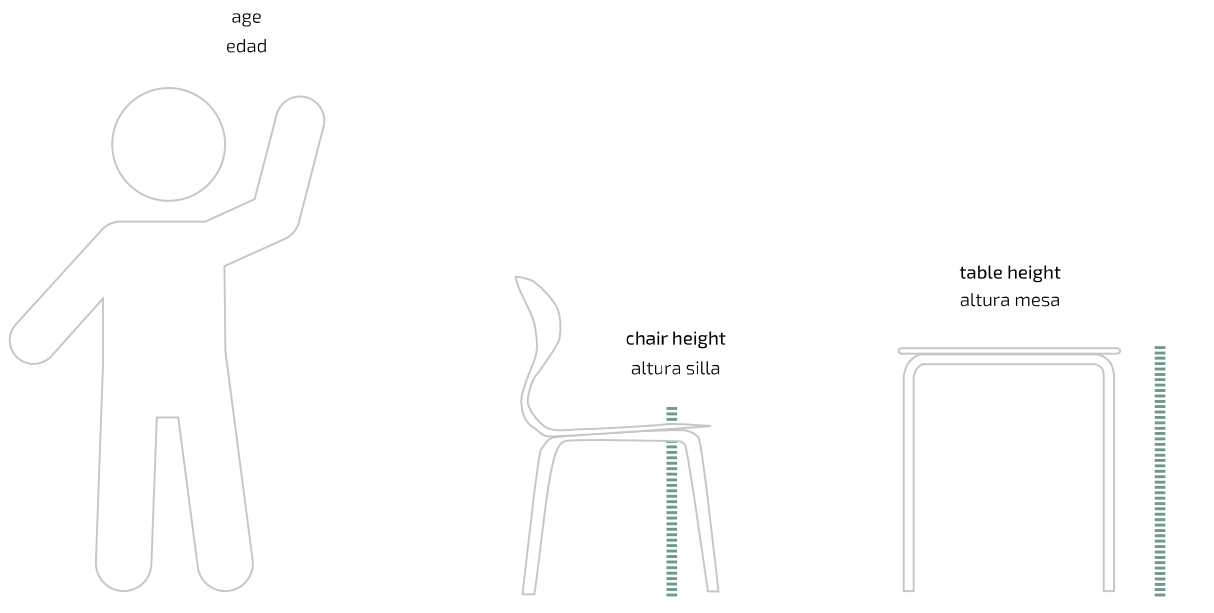

SIZE TALLA	AGE EDAD	CHAIR HEIGHT ALTURA ASIENTO	TABLE HEIGHT ALTURA MESA
0	1-2	21 cm	40 cm
1	2-3	26 cm	46 cm
2	3-4	30 cm	52 cm
3	4-6	34 cm	59 cm
4	6-8	38 cm	65 cm
5	8-10	42 cm	70 cm
6	+12	46 cm	77 cm
8*	+8	80 cm	100 cm

Size according to European regulation UNE EN 1729-1: 07 / UNE EN 1729-2: 07.

Tallas según la normativa europea UNE EN 1729-1: 07 / UNE EN 1729-2: 07.

*Equivalence UNE-EN 1729-1 size 5 dimensions for tables to work standing up.

*Equivalencia UNE-EN 1729-1 a dimensiones talla 5 para mesas de trabajo de pie.

Our products are designed and manufactured according to the corresponding implementation regulations:

Chairs and tables for educational institutions.

UNE EN 1729-1: 07 / UNE EN 1729-2: 07.

Dimensions, safety requirements and test methods.

According to UNE 56843:01 furniture specifications.

UNE-EN 71-3:94 - Migration of metallic elements.

Mirplay certifies its products in European laboratories SGS.

Nuestros productos estan diseñados y fabricados según las normativas de aplicación correspondientes. Relación de normas aplicables:

Sillas y mesas para centros educativos.

UNE EN 1729-1: 07 / UNE EN 1729-2: 07.

Dimensiones, requisitos de seguridad y métodos de ensayo.

Según especificaciones UNE 56.843: 01 mobiliario.

UNE - EN 71-3: 94 - Migración elementos metálicos.

Mirplay certifica sus productos en el laboratorio de referencia internacional SGS.



* Minimum of 60% post-consumer recycled plastic

* Mínimo 60% de plástico reciclado post-consumer



AEN-COC-000451

The catalogue's images have not a contractual value. They are illustrative and they cannot correspond exactly with the product. The images shown in this catalogue are property of Mobles Mir i Equipaments, its reproduction, distribution, public communication and transformation are forbidden without authorization.

Las imágenes de este catálogo no tienen un valor contractual. Son ilustrativas y podrían no corresponder exactamente al producto. Las imágenes que aparecen en este catálogo son propiedad de Mobles Mir i Equipaments, queda prohibida su reproducción, distribución, comunicación pública y transformación, sin autorización.



Nirplay

COMPANY
GEOGRAPHY